



Clean-Trace™

---

# Product Instructions AQT200

 **EN** Water Plus - Total ATP

**key**diagnostics

T: 02 8212 4074

[info@keydiagnostics.com.au](mailto:info@keydiagnostics.com.au)

[www.keydiagnostics.com.au](http://www.keydiagnostics.com.au)

PO Box 2725, Taren Point, NSW, 2229



# Clean-Trace™

# Product Instructions

## Water Plus - Total ATP

### Description

The 3M™ Clean-Trace™ Water Plus - Total ATP test is a single-use device that contains sample collection rings for the collection of an aqueous sample to rapidly assess the standards of hygiene and sanitation procedures for equipment and the efficiency of Clean In Place (CIP) procedures by the rapid measurement of the total ATP in the rinse water [figure 1]. The total ATP in process water(s), water tanks and cooling towers may also be measured to assess the effect of biocide treatment. ATP is an indicator of organic residues and microorganisms. The sample collection rings are coated with a cationic agent to aid in the collection of a liquid sample and the release of Adenosine Triphosphate (ATP) from intact cells. Upon activation of the test, reagent in the cuvette of the device reacts with ATP collected on the sample collection rings to produce light. The intensity of the light is proportional to the amount of ATP and therefore the degree of contamination. Measurement of the light requires the use of a 3M™ Clean-Trace™ NG Luminometer and the results are displayed in Relative Light Units (RLU). The test kit contains 100 ready to use test devices packaged as units of 10 per individual foil pouch.

### ⚠ SAFETY INFORMATION

Please read, understand and follow all safety information contained in these instructions prior to use of this test device. Consult the Material Safety Data Sheet for additional information including regulations for disposal, especially disposal of unused test devices.

### ⚠ CAUTION

To reduce the risks associated with environmental contamination which, if not avoided, could result in minor or moderate injury:

- After use, follow industry standards for disposal of waste including used or expired test devices.

### Notices

Please read, understand and follow all safety information contained in these instructions prior to use of this device.

Consult the Material Safety Data Sheet for additional information including disposal of unused devices.

To avoid inaccurate RLU readings: do not touch or contaminate the device or the water sample to be tested.

To avoid inaccurate RLU readings: do not insert the sample stick too deep into the sample, only the sample rings should be immersed.

To avoid inaccurate results: do not use a sample more than once, or for subsequent testing (ATP or microbiological).

To avoid inaccurate RLU readings: do not use devices beyond the expiration date.

To avoid inaccurate results: do not use test in direct sunlight.

To avoid inaccurate results: do not use non-3M Luminometers to read the test results.

To avoid inaccurate results: do not use the test results to determine the water quality for drinking or as an ingredient in foods or beverages.

### User Responsibility

Users are responsible for familiarizing themselves with product instructions and information. Visit our website at [www.3M.com/foodsafety](http://www.3M.com/foodsafety), or contact your local 3M representative or distributor for more information.

When selecting a test method, it is important to recognize that external factors such as sampling methods, testing protocols, sample preparation, handling, and laboratory technique may influence results.

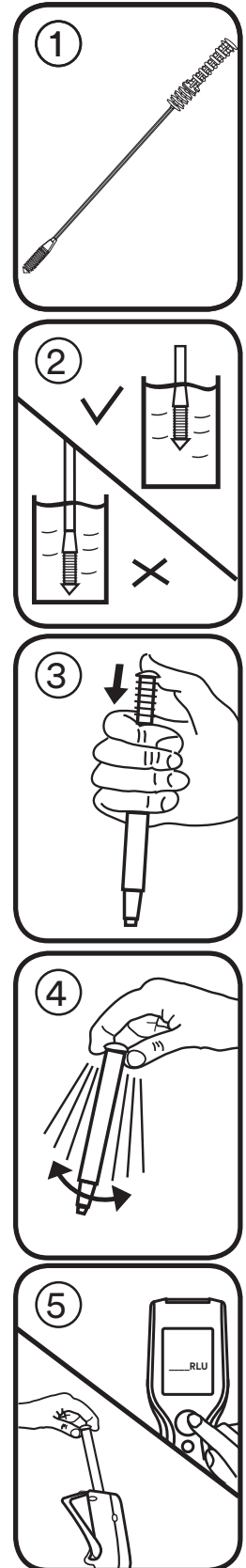

It is the user's responsibility in selecting any test method or product to evaluate a sufficient number of samples with the appropriate matrices and microbial challenges to satisfy the user that the chosen test method meets the user's criteria.

It is also the user's responsibility to determine that any test methods and results meet its customers' and suppliers' requirements.

As with any test method, results obtained from use of any 3M Food Safety product do not constitute a guarantee of the quality of the matrices or processes tested.

### **Limitation of Warranties / Limited Remedy**

EXCEPT AS EXPRESSLY STATED IN A LIMITED WARRANTY SECTION OF INDIVIDUAL PRODUCT PACKAGING, 3M DISCLAIMS ALL EXPRESS AND IMPLIED WARRANTIES, INCLUDING BUT NOT LIMITED TO, ANY WARRANTIES OF MERCHANTABILITY OR FITNESS FOR A PARTICULAR USE. If any 3M Food Safety Product is defective, 3M or its authorized distributor will, at its option, replace or refund the purchase price of the product. These are your exclusive remedies. You must promptly notify 3M within sixty days of discovery of any suspected defects in a product and return it to 3M. Please call Customer Service (1-800-328-1671 in the U.S.) or your official 3M Food Safety representative for a Returned Goods Authorization.

### **Limitation of 3M Liability**

3M WILL NOT BE LIABLE FOR ANY LOSS OR DAMAGES, WHETHER DIRECT, INDIRECT, SPECIAL, INCIDENTAL OR CONSEQUENTIAL DAMAGES, INCLUDING BUT NOT LIMITED TO LOST PROFITS. In no event shall 3M's liability under any legal theory exceed the purchase price of the product alleged to be defective.

### **Storage and Disposal**

For maximum shelf life of 12 months, store between 2°C - 8°C (36°F - 46°F), or store at 21°C - 25°C (70°F - 77°F) for 2 months shelf life. Store in pouch until time of use. If continually stored at 21°C - 25°C (70°F - 77°F), do not use after 2 months. Expiry date and lot number are noted on each pouch.

### **Instructions for Use**

Before the 3M Clean-Trace Water Plus - Total ATP test device is activated, it is important to ensure your 3M™ Clean-Trace™ NG Luminometer is switched on and initialized. Refer to the manual provided with the instrument for full details.

1. Place the 3M Clean-Trace Water Plus - Total ATP test devices at room temperature for at least 10 minutes before use if devices were stored at 2°C - 8°C (36°F - 46°F). Optimal room temperature for the test is 15°C - 30°C (59°F - 86°F).
2. Collect liquid samples from the test sites of interest. Process each sample through steps 3-6. Process each sample before processing the next sample.
3. Swirl to mix the sample. Remove a 3M Clean-Trace Water Plus - Total ATP test device from the foil pouch. Remove the sample stick from the test device and immerse the sample collection rings into the liquid under test only to the top of the rings, tapping the handle gently if bubbles form [figure 2]. Immediately remove the sample stick from the solution to be tested and carefully return the sample stick to the test device such that the handle is at its starting position.
4. To process the sample, push down firmly on the top of the 3M Clean-Trace Water Plus - Total ATP sample stick handle [figure 3]. The handle will slide into the test device tube and the top of the handle should be level with the top of the test device tube when fully depressed. Grip the top of the device and shake rapidly side-to-side for at least five seconds to mix the sample and reagent [figure 4].
5. Immediately open the sample chamber of the 3M Clean-Trace NG Luminometer and insert the 3M Clean-Trace Water Plus - Total test device. Close the chamber cap and press the measure button. The light emitted by the 3M Clean-Trace Water Plus - Total ATP test will be measured and the result (in RLU) will appear on the display [figure 5].



## How to best utilize 3M™ Clean-Trace™ Water Plus - Total ATP

| Do   | Do not   |
|--|--|
| Hold the 3M Clean-Trace Water Plus - Total ATP device in the VERTICAL position on activation and shake rapidly from SIDE TO SIDE for at least 5 seconds and read immediately in the 3M Clean-Trace NG Luminometer. | Activate when not in the vertical position, do not shake up and down, do not shake aggressively.                                     |
| Use a vessel of at least 25 ml (>20 mm diameter).  | Use a test tube or other small diameter vessel for samples.  |
| Sample, activate, and measure 3M Clean-Trace Water Plus - Total ATP tests ONE AT A TIME when a number of samples are to be measured.   | Activate all 3M Clean-Trace Water Plus - Total ATP devices and then test one at a time.  |
| Place the 3M Clean-Trace NG Luminometer in the vertical position when a measurement is made.   | Hold the 3M Clean-Trace NG Luminometer horizontally or lay down on the bench to read a 3M Clean-Trace Water Plus - Total ATP device. |
| Always remove the last 3M Clean-Trace Water Plus - Total ATP device from the 3M Clean-Trace NG Luminometer chamber when the measurement is completed.  | Leave a 3M Clean-Trace Water Plus - Total ATP test device in the chamber when the measurement is completed.                          |

### Interpretation

- The higher the RLU number, the more contaminated the sample.
- It is required that you set predetermined pass/fail levels so that users of the system know what action is required once the result is known.
- Even a perfectly clean sample will not give a zero RLU test result as the 3M Clean-Trace NG Luminometer instrument and 3M Clean-Trace Water Plus - Total ATP test device have a non-zero “background” RLU test result level.

For detailed advice on establishing pass/fail RLU test result levels, consult the 3M “Hygiene Management Guide” document available on the CD provided with the 3M™ Clean-Trace™ Data Trending software. The process described in this document establishes reference RLU test result levels using RLU test results obtained by you from your normal cleaning procedures to set pass/fail RLU test result levels. You can compare RLU test results from your normal cleaning procedures to control water samples.

For cooling or process water, it is useful to establish a baseline of RLU test result values over time. You can then use this baseline to identify abnormal readings, seasonal variations, and patterns of contamination that may occur with various treatment methods. For further information, contact 3M Food Safety Technical Services.

### Explanation of Symbols



Attention, see instructions for use



The lot in a box and the hourglass symbols represent the lot number and expiry date. The lot in a box is followed by the lot number: (NNN). The hourglass is followed by a day, month and year which represents the expiry date (day, month and year: (DDMMYYYY)).



Store between given temperatures



Protect from direct sunlight

## 3M Food Safety

### 3M United States

3M Center  
Bldg. 275-5W-05  
St. Paul, MN 55144-1000  
USA  
1-800-328-6553

### 3M Canada

Post Office Box 5757  
London, Ontario N6A 4T1  
Canada  
1-800-563-2921

### 3M Europe and MEA

3M Deutschland GmbH  
Carl-Schurz - Strasse 1  
D41453 Neuss/Germany  
+49-2131-14-3000

### 3M Latin America

3M Center  
Bldg. 275-5W-05  
St. Paul, MN 55144-1000  
USA  
1-954-340-8263

### 3M Asia Pacific

No 1, Yishun Avenue 7  
Singapore, 768923  
65-64508869

### 3M Japan

3M Health Care Limited  
33-1, Tamagawadai 2-chrome  
Setagaya-ku, Tokyo  
158-8583, Japan  
81-570-011-321

### 3M Australia

Bldg A, 1 Rivett Road  
North Ryde, NSW 2113  
Australia  
61 1300 363 878



### 3M Health Care

2510 Conway Ave  
St. Paul, MN 55144 USA  
[www.3M.com/foodsafety](http://www.3M.com/foodsafety)

© 2013, 3M. All rights reserved.  
3M and Clean-Trace are trademarks of 3M. Used under license in Canada.  
34-8710-6650-1