

Growth of
E.coli on
Compact Dry EC

ISO 16140

HyServe

Compact Dry in water analysis

PREPARATION

Filter 100 ml of water (or more, e.g. 250 ml for bottled water)
with a 0,45 µm steril membrane

INOCULATION

Apply the membrane onto Compact Dry plate

INCUBATION

Incubate under the prescribed condition described in package insert

ENUMERATION

Enumerate typical colonies

Color
interpretation
look into
package insert

No confirmation necessary !

keydiagnostics

T: 02 8212 4074 F: 02 9423 6992
info@keydiagnostics.com.au
www.keydiagnostics.com.au
PO Box 1038, Gymea, NSW, 2227

Growth of *S.aureus* on Compact Dry AQ



Growth of *E.coli* on Compact Dry CF



Growth of *E.coli* on Compact Dry EC



Growth of *K.oxytoca* on Compact Dry ETB



Growth of *E.faecalis* on Compact Dry ETC



Growth of *E.coli* on Compact Dry TC



Membrane filter method



1

Take out a Compact Dry plate, take off the cap of a plate, pipette 1mL of sterile purified water in the middle of dry sheet.



2

Open a package of sterilized filter and pick up a sterilized membrane filter with sterilized tweezers.

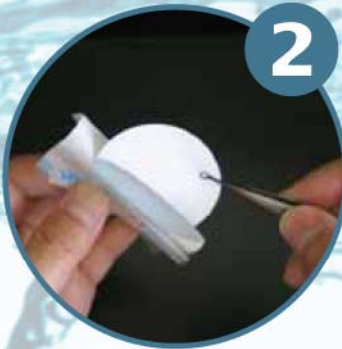

3

Remove the funnel of sterilized filtering device and set a sterilized membrane filter.



4

Set the funnel, pour the sample water in the funnel and filter the sample water under reduced pressure.



5

After the filtering sample, wash the inner surface of funnel with 20 – 30 mL of sterile purified water and filter it. Repeat the same steps two or three times.



6

Detach the funnel and take the membrane filter out with sterilized tweezers. Put on the filter on the prepared Compact Dry plate without bubbles. The trap side is upper.



7

Turn over the plate capped and put in an incubator for incubation under the prescribed condition.



Product overview

	ID-Number	Packaging	Application
Compact Dry AQ	1 002 950	40 plates	Heterotrophic bacteria
	1 002 951	240 plates	
	1 402 951	500 plates	
	1 002 954	920 plates	
	1 402 992	1.200 plates	
Compact Dry CF	1 000 867	40 plates	Coliforms
	1 000 868	240 plates	
	1 400 868	500 plates	
	1 002 879	920 plates	
	1 402 881	1.200 plates	
Compact Dry EC	1 000 168	40 plates	<i>E.coli</i> and coliforms
	1 000 169	240 plates	
	1 400 170	500 plates	
	1 002 878	920 plates	
	1 402 880	1.200 plates	
Compact Dry ETB	1 002 941	40 plates	Enterobacteriaceae
	1 002 942	240 plates	
	1 402 942	500 plates	
	1 002 943	920 plates	
	1 402 889	1.200 plates	
Compact Dry ETC	1 002 944	40 plates	Enterococci
	1 002 945	240 plates	
	1 402 945	500 plates	
	1 002 946	920 plates	
	1 402 993	1.200 plates	
Compact Dry TC	1 000 166	40 plates	Total Count
	1 000 167	240 plates	
	1 400 168	500 plates	
	1 002 877	920 plates	
	1 402 879	1.200 plates	

HyServe

HyServe GmbH & Co. KG.

Hechenrainer Str. 24
82449 Uffing
Germany

www.hyserve.com
info@hyserve.com

Tel +49 (0) 88 46-13 44
Fax +49 (0) 88 46-13 42

keydiagnostics

T: 02 8212 4074 F: 02 9423 6992
info@keydiagnostics.com.au
www.keydiagnostics.com.au
PO Box 1038, Gympie, NSW, 2227