

CrossCheck™

Catalog # CX-3000 / For use with Hygiena Luminometers



CrossCheck is sold in packages of 100 devices

Description and Intended Use

CrossCheck is a rapid bioluminogenic test for the determination of Acid Phosphatase (ACP) activity giving results in less than 5 minutes.

The ACP enzyme is a natural component of raw meat and fish that can also harbor several types of food poisoning bacteria that are pathogenic. The cooking process destroys both the ACP activity and the bacteria.

The presence of ACP activity is an indicator of the hazard associated with raw meat in areas where food is prepared and served, and a measure of the effectiveness of the cooking process.

The CrossCheck device is intended to be used for:

1. Monitoring the cleanliness of surfaces that may have come in contact with raw meat, and assessing the potential risk due to cross-contamination.
2. Measuring the level of ACP activity in cooked meats to verify cooking process.

Principle

CrossCheck consists of a self-contained collection and test device that contains a bioluminogenic chemistry. A specific substrate in the reagent is broken down by the ACP enzyme in the sample and this permits a light reaction to be initiated. The amount of light generated is directly proportional to the amount of ACP present in the sample. The test is very sensitive and can detect small residues (0.1% or less) of raw meat and fish in 2 to 5 minutes.

Optimum Test Procedure

For optimum results giving the highest sensitivity the following procedure is recommended;

1. Allow test devices to equilibrate to room before use. Shake test device by tapping on palm of your hand 5 times to bring droplets of solution to the bottom of the tube.
2. Remove the swab assembly from the device to collect the test sample by swabbing the surface under scrutiny.
3. Replace swab firmly back in swab tube.
4. Shake the tube gently to mix sample with solution in the tube.
5. Activate device by breaking the snap valve and squeezing the bulb to release the detection reagent into the tube.
6. Incubate at 37°C for 5 minutes.
7. Place the device into the Hygiena SystemSURE Plus or EnSURE Luminometer and press "OK" to start the reading
8. Record the result shown as RLUs (Relative Light Units).

Interpretation of Results

For Optimum Test Procedure (37°C for 5 minutes)

The presence of ACP is detected when;

RLU > 15 are obtained with SystemSURE Plus, or
RLU > 30 obtained in the EnSURE luminometer.
See Table 1.

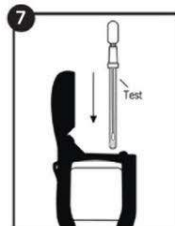
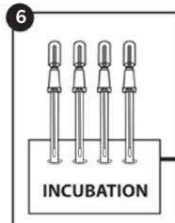
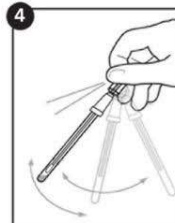
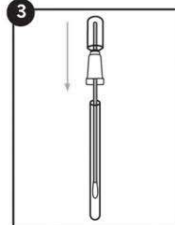

Quick Test Procedure

- A) Repeat steps 1 to 5 above.
- B) Store upright at room temperature (~21°C) for 2 minutes.
- C) Place the device into the Hygiena SystemSURE Plus or EnSURE Luminometer and press "OK" to read results in RLUs (Relative Light Units).

Interpretation of Results

For the Quick Test Procedure (room temperature for 2 min)

The presence of ACP is detected when;

- RLU >8 are obtained with SystemSURE Plus, or
- RLU >15 obtained in the EnSURE luminometer.

See Table 2.

Storage & Shelf Life

- Store bags of devices at 2°C-8°C
- Devices have a shelf life of 12 months. Check expiration date on label.

Caution and User Responsibility

Components of CrossCheck devices do not pose any health risk when used correctly. Used devices should be disposed off in compliance with Good Laboratory Practice and local Health and Safety regulations.

1. Devices are designed for a single use. Do not reuse.
2. Do not use devices after Expiration date.
3. Sampling should be done aseptically, to avoid cross contamination.
4. Ensure proper incubation temperature and time.
5. When activating devices, ensure that all the liquid in the bulb is transferred to the tube below.
6. The devices are light sensitive. Do not leave devices out of the bag for long periods of time.

Hygiena Liability

Hygiena will not be liable to user or others for any loss or damage whether direct or indirect, incidental or consequential from use of this device. If this product is proven to be defective, Hygiena's sole obligation will be to replace product or at its discretion, refund the purchase price. Promptly notify Hygiena within 5 days of discovery of any suspected defect and return product to Hygiena. Please call Customer Service for a Returned Goods Authorization.

Contact Information

If more information is required, please visit us at www.hygiena.com, or contact us at:

Hygiena USA

941 Avenida Acaso
Camarillo, CA 93012
Phone: 805.388.8007
Fax: 805.388.5531
Email:
info@hygiena.com

Hygiena International

Unit 11 Wenta Business
Centre,
Colne Way, Watford,
Hertfordshire WD24 7ND
UK
Phone: +44 (0)1923 818821
Fax: +44 (0)1923 818825
Email:
enquiries@hygiena.com

CrossCheck™

Catalog # CX-3000 / For use with Hygiena Luminometers



CrossCheck is sold in packages of 100 devices

Table 1 Detection of Raw Chicken in 5 minutes at 37°C

% Chicken Drip	EnSURE RLU	SystemSURE RLU	Interpretation
10%	3213	1292	Positive
1%	1298	715	Positive
0.10%	178	84	Positive
0.01%	29	10	Negative
0.001%	25	8	Negative
0%	25	14	Negative

Table 2 Detection of Raw Chicken in 2 minutes at Room Temperature (~21°C)

% Chicken Drip	EnSURE RLU	SystemSURE RLU	Interpretation
10%	182	89	Positive
1%	58	28	Positive
0.10%	21	9	Positive
0.01%	12	6	Negative
0.001%	12	7	Negative
0%	6	5	Negative



Tel : 02 8212 4074

Fax:02 9423 6992

PO Box 1038

GyMEA NSW 2227

info@keydiagnostics.com.au

www.keydiagnostics.com.au